

This document is the property of Amphenol Corporation and is loaned to the customer for use in the manufacture of products. It is not to be reproduced, stored in a retrieval system, or transmitted in any form or by any means, electronic, mechanical, photocopying, recording, or by any information storage and retrieval system, without the prior written permission of Amphenol Corporation. For more information, see the document or for any other information, in this document.

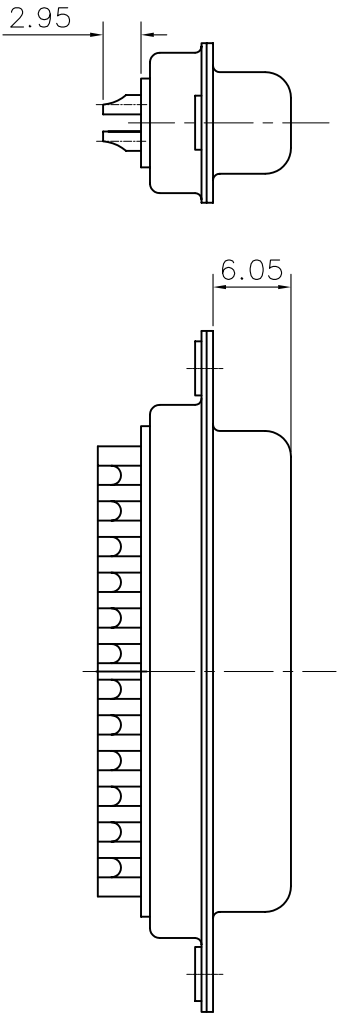
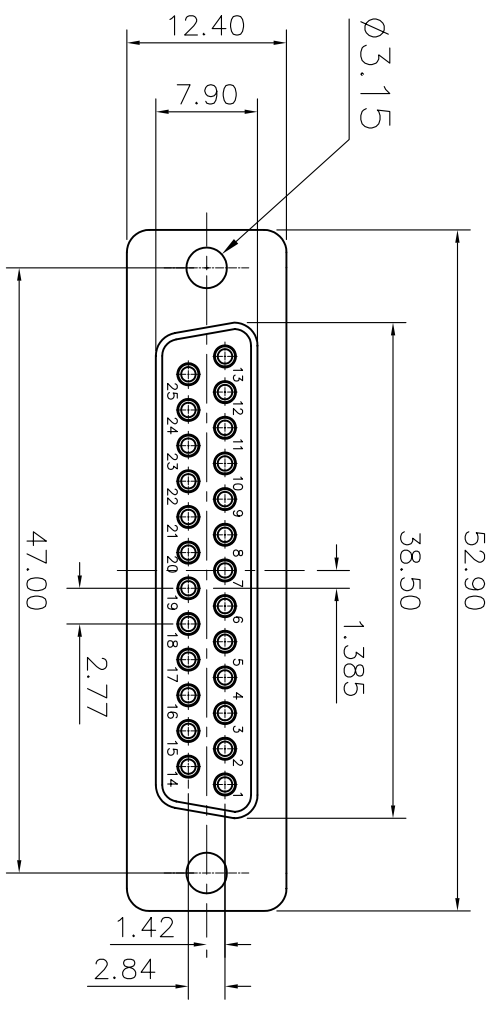

REVISONS		DATE	APPROVED
1	DESCRIPTION	07/27/07	
2			
3			
4			

D-SUB TECHNICAL DATA

SHELL :Brass 2.5um (100u") min tin over 1.25um (50u") min nickel
 BODY : Glass filled thermoplastic.
 Flame retardant to UL94 V-0 Color Black
 CONTACTS : brass.
 0.1um (4u") min gold over 1.25um (50u") min nickel
 ELECTRICAL : Voltage rating : 1000 V RMS at 50 Hz
 Current rating 7.5A.
 Insulation resistance >5000 M Ohms
 Contact resistance 20 mOhms max.
 CLIMATIC : Temperature range -55 °C up to 85°C
 Damp heat 21 days(40 °C-95% HR)
 MARKING : Amphenol...(Series No.)
 Commercial reference
 Manufacturing date

PRODUCT CODE

L77DB25S

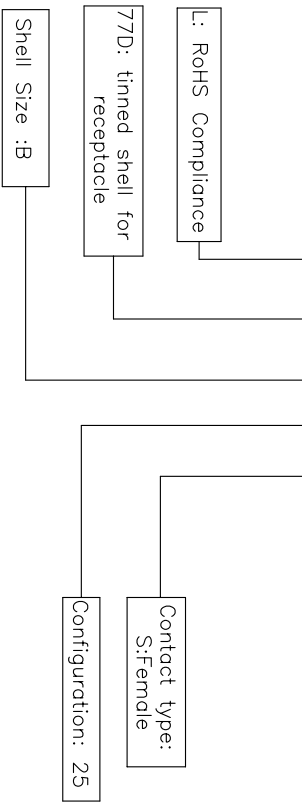

UNLESS OTHERWISE SPECIFIED		APPROVAL		DATE
TOLERANCES		DRAWN	Issue going	07/27/07
U.S.		CHECKED	148.using	07/27/07
METRIC				
X	++			
XX	+/-			
XXX	-/-			
FRACTIONS +/-				
ANGLES +/-				
Z'				
FOR MATERIALS AND FINISHES				
REMOVE SHARP EDGES				
SEE NOTES				
DRAWING FILE :				
ANGLE OF PROJECTION				
DIMENSIONS				
U.S.	INCHES			
METRIC	MM			
TITLE		machined contacts connector, D series		
SIZE		DRAWING NO. C L77DB25S		
SCALE		NONE		
SHEET		1 OF 1		
REV.		A		