

DRAWING NUMBER:	15-214-X-XX
PRODUCT GROUP:	TERMINALS
SUB-GROUP:	MILITARY NON-INSULATED TERMINALS
DESCRIPTION:	NON-INSULATED DOUBLE TURRET TERMINAL

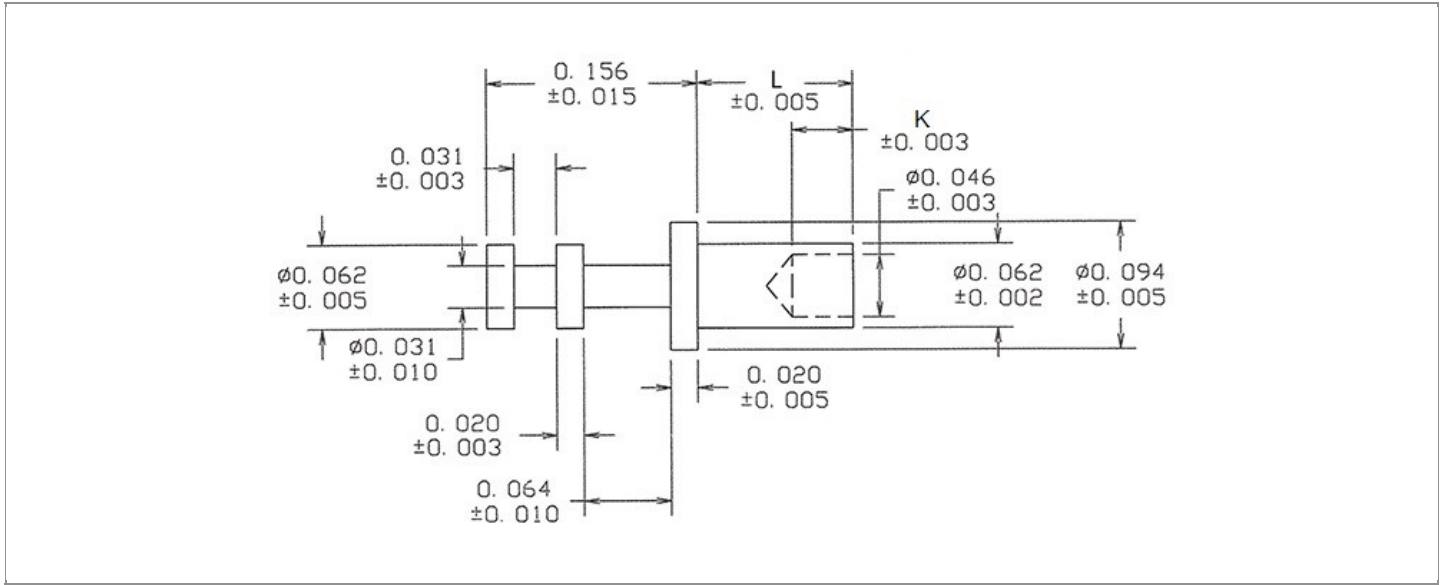

BOARD / PANEL MOUNTING METHOD	MOUNTING HOLE SIZE	DRILL SIZE	FEED THRU COMBINATION
SWAGE MOUNT	0.067" ± 0.001	#51	N/A

PART NO. STRUCTURE:

15-214 - X - XX
 PART SERIES DIMENSION FINISH

MATERIAL OPTIONS:

15-214-X-XX

COMPONENT	MATERIAL	MATERIAL AND SPECIFICATION
TERMINAL	BRASS	BRASS PER ASTM B16, ALLOY C36000, 1/2 HARD

DIMENSION OPTIONS:

15-214-X-XX

DIMENSION	K	OVERALL LENGTH	SHANK LENGTH (L)	BOARD/PANEL THICKNESS
1	0.045"	0.209"	0.053"	1/32"
2	0.045"	0.240"	0.084"	1/16"
3	0.045"	0.271"	0.115"	3/32"
4	0.045"	0.303"	0.147"	1/8"
11	0.025"	0.193"	0.037"	1/64"

FINISH - PLATING OPTIONS:

15-214-X-**XX**

FINISH CODE	COMPONENT	FINISH	FINISH AND SPECIFICATION
05	TERMINAL	ELECTRO-SOLDER	0.000300"MIN. ELECTRO-SOLDER PER SAE-AMS-P-81728 OVER 0.000100"MIN. COPPER PER SAE-AMS-2418
088	TERMINAL	BRIGHT TIN-LEAD	0.000300"MIN. BRIGHT TIN-LEAD (Sn93%-Pb7%) PER ASTM B545 OVER 0.000100"MIN. COPPER PER SAE-AMS-2418
095	TERMINAL	HOT SOLDER DIP	0.000100"MIN. HOT SOLDER DIP USING Sn60 PER IPC-J-STD-006 OVER 0.000100"MIN. COPPER PER SAE-AMS-2418

TOLERANCES:*

DECIMAL	FRACTIONAL	ANGULAR	DRAWING ORIGATION DATE	LAST MODIFICATION DATE
N/A	N/A	N/A	10/31/2002	3/1/2017

*All dimensions are in inches.

RoHS COMPLIANCE:

15-214-1-XX

PART NUMBER	RoHS COMPLIANT
15-214-1-05	NO
15-214-1-088	NO
15-214-1-095	NO

15-214-2-XX

PART NUMBER	RoHS COMPLIANT
15-214-2-05	NO
15-214-2-088	NO
15-214-2-095	NO

15-214-3-XX

PART NUMBER	RoHS COMPLIANT
15-214-3-05	NO
15-214-3-088	NO
15-214-3-095	NO

15-214-4-XX

PART NUMBER	RoHS COMPLIANT
15-214-4-05	NO
15-214-4-088	NO
15-214-4-095	NO

15-214-11-XX

PART NUMBER	RoHS COMPLIANT
15-214-11-05	NO
15-214-11-088	NO
15-214-11-095	NO

MILITARY REFERENCE SPECIFICATIONS:

15-214-1-XX

PART NUMBER	MIL SPECIFICATION	MIL PART NUMBER	COMMERCIAL ITEM DESCRIPTION (CID) SPECIFICATION	CID PART NUMBER
15-214-1-05	MIL-T-55155/30	M55155/30XH02 (SE30XC02S)	A-A-59126/30	AA59126/30XH02
15-214-1-088	MIL-T-55155/30	M55155/30XJ02	A-A-59126/30	AA59126/30XJ02 (AA59126/3002)
15-214-1-095	MIL-T-55155/30	M55155/30XI02	A-A-59126/30	AA59126/30XI02

15-214-2-XX

PART NUMBER	MIL SPECIFICATION	MIL PART NUMBER	COMMERCIAL ITEM DESCRIPTION (CID) SPECIFICATION	CID PART NUMBER
15-214-2-05	MIL-T-55155/30	M55155/30XH05 (SE30XC05S)	A-A-59126/30	AA59126/30XH05

Continued on next page...

MILITARY REFERENCE SPECIFICATIONS CONTINUED:

15-214-2-XX

PART NUMBER	MIL SPECIFICATION	MIL PART NUMBER	COMMERCIAL ITEM DESCRIPTION (CID) SPECIFICATION	CID PART NUMBER
15-214-2-088	MIL-T-55155/30	M55155/30XJ05	A-A-59126/30	AA59126/30XJ05 (AA59126/3005)
15-214-2-095	MIL-T-55155/30	M55155/30XI05	A-A-59126/30	AA59126/30XI05

15-214-3-XX

PART NUMBER	MIL SPECIFICATION	MIL PART NUMBER	COMMERCIAL ITEM DESCRIPTION (CID) SPECIFICATION	CID PART NUMBER
15-214-3-05	MIL-T-55155/30	M55155/30XH09 (SE30XC09S)	A-A-59126/30	AA59126/30XH09
15-214-3-088	MIL-T-55155/30	M55155/30XJ09	A-A-59126/30	AA59126/30XJ09 (AA59126/3009)
15-214-3-095	MIL-T-55155/30	M55155/30XI09	A-A-59126/30	AA59126/30XI09

15-214-4-XX

PART NUMBER	MIL SPECIFICATION	MIL PART NUMBER	COMMERCIAL ITEM DESCRIPTION (CID) SPECIFICATION	CID PART NUMBER
15-214-4-05	MIL-T-55155/30	M55155/30XH13 (SE30XC13S)	A-A-59126/30	AA59126/30XH13
15-214-4-088	MIL-T-55155/30	M55155/30XJ13	A-A-59126/30	AA59126/30XJ13 (AA59126/3013)
15-214-4-095	MIL-T-55155/30	M55155/30XI13	A-A-59126/30	AA59126/30XI13

15-214-11-XX

PART NUMBER	MIL SPECIFICATION	MIL PART NUMBER	COMMERCIAL ITEM DESCRIPTION (CID) SPECIFICATION	CID PART NUMBER
15-214-11-05	MIL-T-55155/30	M55155/30XH01 (SE30XC01S)	A-A-59126/30	AA59126/30XH01
15-214-11-088	MIL-T-55155/30	M55155/30XJ01	A-A-59126/30	AA59126/30XJ01 (AA59126/3001)
15-214-11-095	MIL-T-55155/30	M55155/30XI01	A-A-59126/30	AA59126/30XI01

TOOLING:

INSTALLATION TOOL: ARBOR PRESS	INSTALLATION TOOL: ANVIL (ARBOR PRESS OPERATED)	INSTALLATION TOOL: PRESS-FIT / ROLL SWAGE / RIVET PUNCH (ARBOR PRESS OPERATED)	INSTALLATION TOOL: FLARE SWAGE PUNCH (ARBOR PRESS OPERATED)
TM1	TA94-62-20	TP62-44	TFLP90-150

NOTES:

DATASHEET NOTES
N/A

INSTRUCTION NOTES
SEE GENERAL SWAGING INSTALLATION INSTRUCTION ON CONCORD ELECTRONICS' WEBSITE WWW.CONCORD-ELECTRONICS.COM