

<b>DRAWING NUMBER:</b>	<b>15-601-X-XX</b>
<b>PRODUCT GROUP:</b>	TERMINALS
<b>SUB-GROUP:</b>	MILITARY NON-INSULATED TERMINALS
<b>DESCRIPTION:</b>	NON-INSULATED TRIPLE TURRET TERMINAL

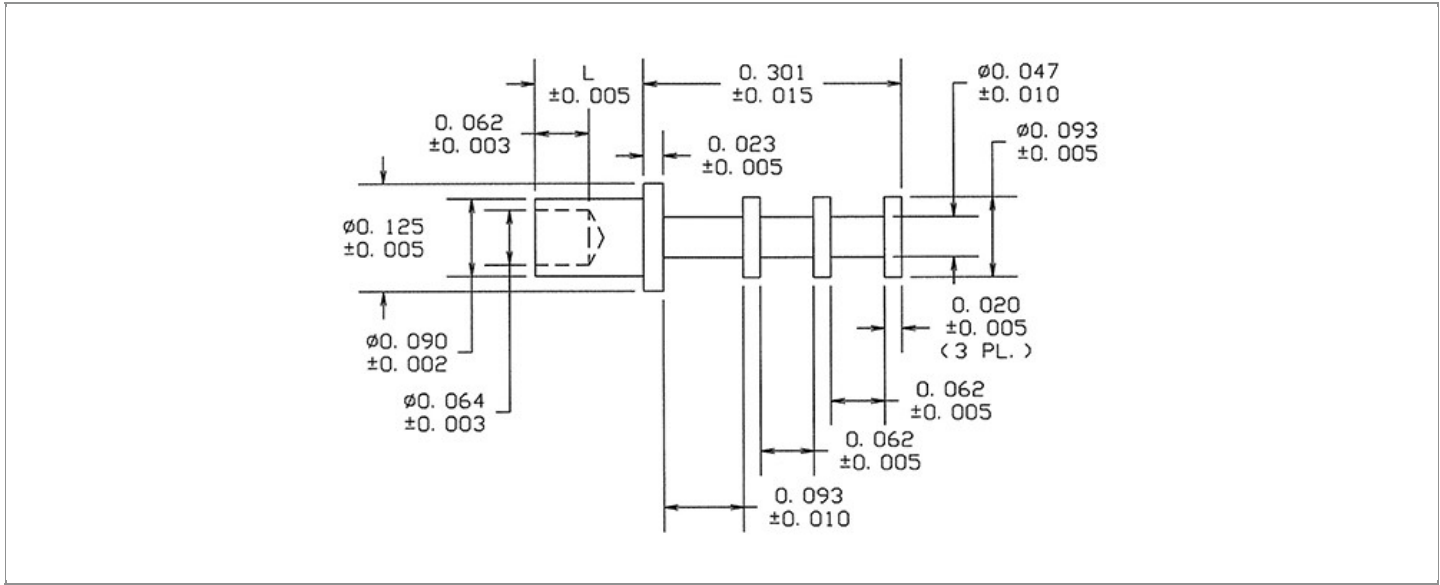

BOARD / PANEL MOUNTING METHOD	MOUNTING HOLE SIZE	DRILL SIZE	FEED THRU COMBINATION
SWAGE MOUNT	0.094" $\pm$ 0.001	3/32"	N/A

**PART NO. STRUCTURE:**

15-601 - X - XX  
 PART SERIES    DIMENSION    FINISH

**MATERIAL OPTIONS:**

15-601-X-XX

COMPONENT	MATERIAL	MATERIAL AND SPECIFICATION
TERMINAL	BRASS	BRASS PER ASTM B16, ALLOY C36000, 1/2 HARD

**DIMENSION OPTIONS:**

15-601-X-XX

DIMENSION	K	OVERALL LENGTH	SHANK LENGTH (L)	BOARD/PANEL THICKNESS
1	N/A	0.363"	0.062"	1/32"
2	N/A	0.394"	0.093"	1/16"
3	N/A	0.426"	0.125"	3/32"
4	N/A	0.457"	0.156"	1/8"
6	N/A	0.519"	0.218"	3/16"

## FINISH - PLATING OPTIONS:

15-601-X-**XX**

FINISH CODE	COMPONENT	FINISH	FINISH AND SPECIFICATION
05	TERMINAL	ELECTRO-SOLDER	0.000300"MIN. ELECTRO-SOLDER PER SAE-AMS-P-81728 OVER 0.000100"MIN. COPPER PER SAE-AMS-2418
088	TERMINAL	BRIGHT TIN-LEAD	0.000300"MIN. BRIGHT TIN-LEAD (Sn93%-Pb7%) PER ASTM B545 OVER 0.000100"MIN. COPPER PER SAE-AMS-2418
095	TERMINAL	HOT SOLDER DIP	0.000100"MIN. HOT SOLDER DIP USING Sn60 PER IPC-J-STD-006 OVER 0.000100"MIN. COPPER PER SAE-AMS-2418

## TOLERANCES:\*

DECIMAL	FRACTIONAL	ANGULAR	DRAWING ORIGATION DATE	LAST MODIFICATION DATE
N/A	N/A	N/A	11/4/2002	3/1/2017

\*All dimensions are in inches.

## RoHS COMPLIANCE:

## 15-601-1-XX

PART NUMBER	RoHS COMPLIANT
15-601-1-05	NO
15-601-1-088	NO
15-601-1-095	NO

## 15-601-2-XX

PART NUMBER	RoHS COMPLIANT
15-601-2-05	NO
15-601-2-088	NO
15-601-2-095	NO

## 15-601-3-XX

PART NUMBER	RoHS COMPLIANT
15-601-3-05	NO
15-601-3-088	NO
15-601-3-095	NO

## 15-601-4-XX

PART NUMBER	RoHS COMPLIANT
15-601-4-05	NO
15-601-4-088	NO
15-601-4-095	NO

## 15-601-6-XX

PART NUMBER	RoHS COMPLIANT
15-601-6-05	NO
15-601-6-088	NO
15-601-6-095	NO

## MILITARY REFERENCE SPECIFICATIONS:

## 15-601-1-XX

PART NUMBER	MIL SPECIFICATION	MIL PART NUMBER	COMMERCIAL ITEM DESCRIPTION (CID) SPECIFICATION	CID PART NUMBER
15-601-1-05	MIL-T-55155/31	M55155/31XH01 (SE31XC01S)	A-A-59126/31	AA59126/31XH01
15-601-1-088	MIL-T-55155/31	M55155/31XJ01	A-A-59126/31	AA59126/31XJ01 (AA59126/3101)
15-601-1-095	MIL-T-55155/31	M55155/31XI01	A-A-59126/31	AA59126/31XI01

## 15-601-2-XX

PART NUMBER	MIL SPECIFICATION	MIL PART NUMBER	COMMERCIAL ITEM DESCRIPTION (CID) SPECIFICATION	CID PART NUMBER
15-601-2-05	MIL-T-55155/31	M55155/31XH03 (SE31XC03S)	A-A-59126/31	AA59126/31XH03

Continued on next page...

MILITARY REFERENCE SPECIFICATIONS CONTINUED:

15-601-2-XX

PART NUMBER	MIL SPECIFICATION	MIL PART NUMBER	COMMERCIAL ITEM DESCRIPTION (CID) SPECIFICATION	CID PART NUMBER
15-601-2-088	MIL-T-55155/31	M55155/31XJ03	A-A-59126/31	AA59126/31XJ03 (AA59126/3103)
15-601-2-095	MIL-T-55155/31	M55155/31XI03	A-A-59126/31	AA59126/31XI03

15-601-3-XX

PART NUMBER	MIL SPECIFICATION	MIL PART NUMBER	COMMERCIAL ITEM DESCRIPTION (CID) SPECIFICATION	CID PART NUMBER
15-601-3-05	MIL-T-55155/31	M55155/31XH05 (SE31XC05S)	A-A-59126/31	AA59126/31XH05
15-601-3-088	MIL-T-55155/31	M55155/31XJ05	A-A-59126/31	AA59126/31XJ05 (AA59126/3105)
15-601-3-095	MIL-T-55155/31	M55155/31XI05	A-A-59126/31	AA59126/31XI05

15-601-4-XX

PART NUMBER	MIL SPECIFICATION	MIL PART NUMBER	COMMERCIAL ITEM DESCRIPTION (CID) SPECIFICATION	CID PART NUMBER
15-601-4-05	MIL-T-55155/31	M55155/31XH07 (SE31XC07S)	A-A-59126/31	AA59126/31XH07
15-601-4-088	MIL-T-55155/31	M55155/31XJ07	A-A-59126/31	AA59126/31XJ07 (AA59126/3107)
15-601-4-095	MIL-T-55155/31	M55155/31XI07	A-A-59126/31	AA59126/31XI07

15-601-6-XX

PART NUMBER	MIL SPECIFICATION	MIL PART NUMBER	COMMERCIAL ITEM DESCRIPTION (CID) SPECIFICATION	CID PART NUMBER
15-601-6-05	MIL-T-55155/31	M55155/31XH10 (SE31XC10S)	A-A-59126/31	AA59126/31XH10
15-601-6-088	MIL-T-55155/31	M55155/31XJ10	A-A-59126/31	AA59126/31XJ10 (AA59126/3110)
15-601-6-095	MIL-T-55155/31	M55155/31XI10	A-A-59126/31	AA59126/31XI10

TOOLING:

INSTALLATION TOOL: ARBOR PRESS	INSTALLATION TOOL: ANVIL (ARBOR PRESS OPERATED)	INSTALLATION TOOL: PRESS-FIT / ROLL SWAGE / RIVET PUNCH (ARBOR PRESS OPERATED)	INSTALLATION TOOL: FLARE SWAGE PUNCH (ARBOR PRESS OPERATED)
TM1	TA125-94-23	TP90-64	TFLP90-175

NOTES:

<b>DATASHEET NOTES</b>
------------------------

N/A

<b>INSTRUCTION NOTES</b>
--------------------------

SEE GENERAL SWAGING INSTALLATION INSTRUCTION ON CONCORD ELECTRONICS' WEBSITE [WWW.CONCORD-ELECTRONICS.COM](http://WWW.CONCORD-ELECTRONICS.COM)