

# MW125

MEDICAL 15-40 WATT SERIES



## MW125 SWITCH-MODE POWER SUPPLY

- 100-250 VAC Universal Input
- Desktop / Wallmount Styles
- Single Output Up to 48W
- Regulated Output With Low Ripple
- Meets Medical Safety Agency Requirements
- Complies With EMI/RFI Regulations
- CE Compliant
- Impact Resistant Polycarbonate Enclosure
- Private Label Marking Available
- 3 Year Warranty
- Modified and Custom Designs Also Available

### MW125

Ault Part No.	Voltage DC	Max Amps	Max Watts	Ripple p-p Max
MW125XA0303_01	3V	5.00	15.0	50mV
MW125XA0503_01	5V	5.00	25.0	50mV
MW125XA0703_01	7V	4.50	31.5	70mV
MW125XA0903_01	9V	4.00	36.0	100mV
MW125XA1203_01	12V	3.00	36.0	120mV
MW125XA1503_01	15V	2.50	37.5	150mV
MW125XA1803_01	18V	2.10	37.5	180mV
MW125XA2403_01	24V	1.67	40.0	240mV
MW125XA4803_01	48V	0.84	40.0	480mV

### Ault Part No. Key

Product Family Name	Manufacturing Location (volume dependent)	Design Revision Changes	Voltage DC	Connector	Input Configuration/ Model Type (see pg. 2)	Standard (no modifications, special artwork or special packaging)
MW125 X	A	05	03	—	01	



AULT INCORPORATED

7105 Northland Terrace | Minneapolis, Minnesota 55428 | USATEL (1) 763-592-1900

FAX (1) 763-592-1911 | E-MAIL [info@aultinc.com](mailto:info@aultinc.com) | WEB [www.aultinc.com](http://www.aultinc.com)

© Copyright 2002 Ault Inc.

# MW125

## MEDICAL 15-40 WATT SERIES

### Input

Voltage	100-240 VAC -10%, +10%
Line Frequency	47-63 Hz
Current	1.0 Amp max. at 90 VAC input
Protection	Internal primary current fuse, Inrush limiting, Thermal shutdown

### Output

Combined Line and Load Voltage Regulation	±1% excluding cord
Ripple	See table
Transient Response	0.5msec. for 50% load change typical
Holdup Time	18 msec min. @ 120 VAC 80 msec min. @ 240 VAC
Protection	Overcurrent protection, Short circuit Protection
Cord and Connector	6 ft, 2 conductor, 18 AWG #3 connector: Other connectors also available.

### Safety Approvals

Agency Listings	cURus2601, TUV/IEC EN60601-1, Australian, Japanese certification available - extra fees apply
-----------------	---

### Electrical

Topology	Switching-fixed frequency flyback
Efficiency	Up to 85%
EMI	Complies with EMC Directives
CE	CE Compliant
MTBF	100,000 Calculated Hours Minimum

### Environmental

Operating Temperature	0° to 40° C with no derating
Storage Temperature	-30° to +85° C
Relative Humidity	5% to 95% non-condensing
Altitude	0-10,000 feet
Cooling	Convectional-non vented case

### Mechanical

Case and Dimensions	All Models 3.92L x 2.58W x 1.61H (in) 100L x 66W x 41H (mm)
Case Material	94V0 polycarbonate; black is standard color; other colors available - extra charges may apply
Weight	Max. 10 ounces, 285 grams (excluding cord)

### Input Configuration



IEC320  
w/ground  
C14  
(F)



IEC320  
w/o ground  
C18  
(Q)



N. America/  
Japan  
(B)



Europe  
(M)



United  
Kingdom  
(G)



Australian  
(E)

Specify the Input Configuration Code in your order.

### Connector

# 3

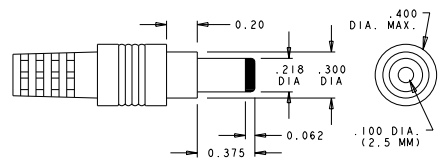

Pinout Code	Center contact: positive
Description	Switchcraft 760 plug or equivalent
Suggested Mating	Switchcraft 712A jack or equivalent
Other Connectors are available by special order	



AULT INCORPORATED

7105 Northland Terrace | Minneapolis, Minnesota 55428 | USATEL (1) 763-592-1900

FAX (1) 763-592-1911 | E-MAIL info@aultinc.com | WEB www.aultinc.com

© Copyright 2002 Ault Inc.