

REV  
NC 1010-117-0306

REVISIONS			
SYM	DESCRIPTION	DATE	APPROVED
NC	NEW RELEASE PER E.O. P19777	3-4-08	RDR

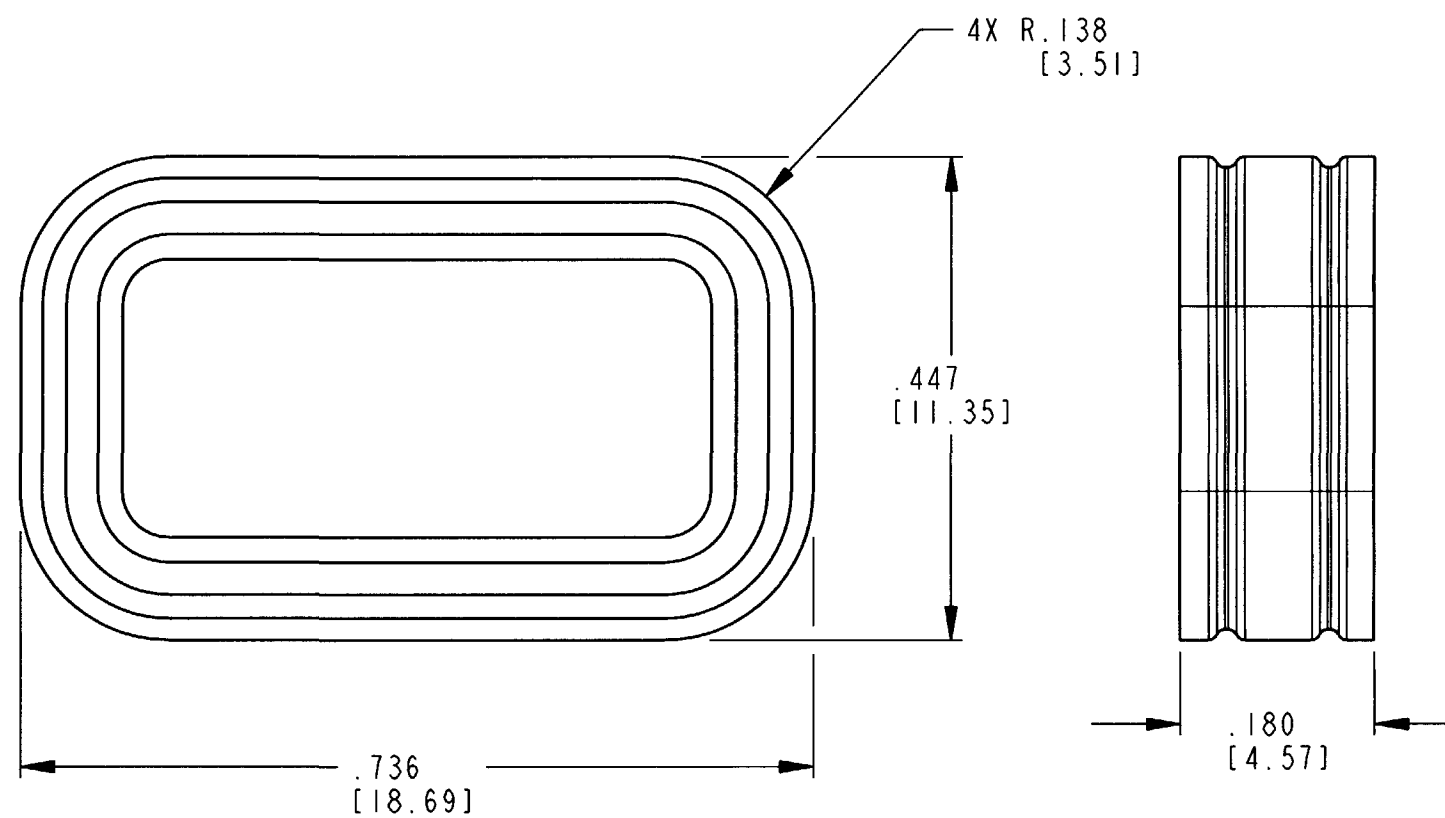
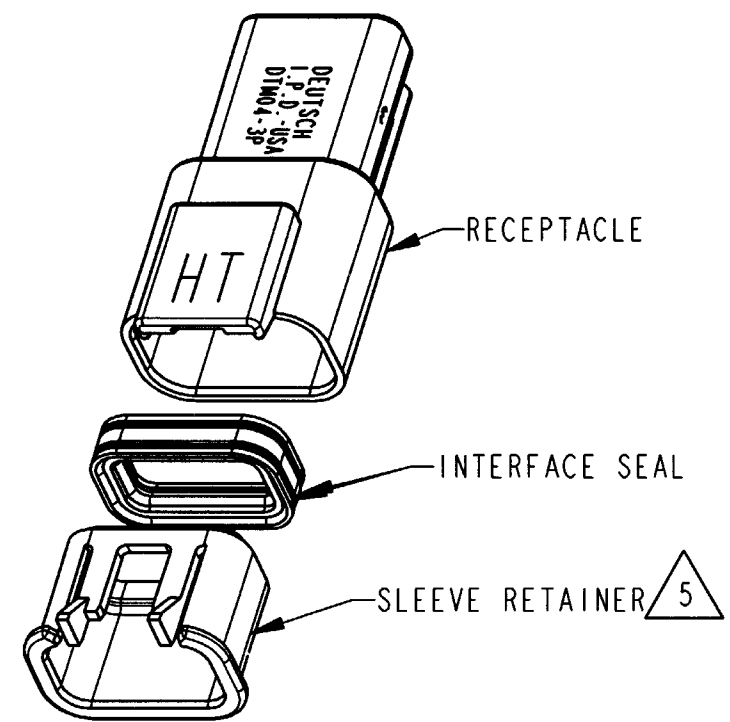

5. ASSEMBLE INTERFACE SEAL AS SHOWN. PUSH INTERFACE SEAL INTO RECEPTACLE. SNAP SLEEVE RETAINER INTO RECEPTACLE. VERIFY SLEEVE RETAINER RETENTION FINGERS ARE FULLY SEATED BEHIND RECEPTACLE LATCH BUMPS. RECEPTACLE AND SLEEVE RETAINER SHOWN FOR REFERENCE ONLY.

- 4. MATERIAL: RUBBER (GREEN) RATED AT 150°C.
  - 3. PART DESIGNED TO BE USED WITH DTM04-3P-\*\*\*\* (\*\*\*\* = ALL MODIFICATIONS), HIGH TEMPERATURE RECEPTACLES ONLY. CONSULT FACTORY FOR MODIFICATIONS
  - 2. DIMENSIONS ARE ±.025 [.64].
  - 1. DIMENSIONS ARE IN INCHES [mm].
- NOTES: UNLESS OTHERWISE SPECIFIED.

SIGNATURE & DATE	
DR	P. CARNAHAN 02/29/08
CHK	<i>[Signature]</i> 3/3/08
PE	<i>[Signature]</i> 2/25/08
APPD	<i>[Signature]</i> 2/29/08
SCALE	NONE

SEAL INTERFACE  
3 PIN RECEPTACLE  
COLOR: GREEN  
DTM SERIES

ENVELOPE

EP 172	MATL CODE
3850 INDUSTRIAL AVE. HEMET, CA 92545	
<b>B</b> 1010-117-0306	
DWG SIZE	CODE 11139 SHEET   OF