

GSD

KM-59-08

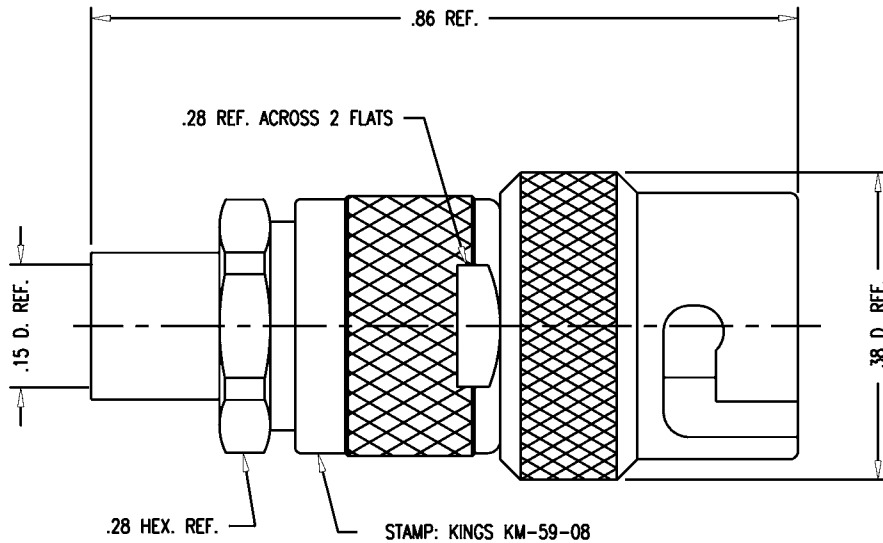

NOTES:

1. FOR USE WITH RG-174, 187, 188 & 316/U CABLE GROUP.
2. FOR CABLING INSTRUCTIONS SEE CP-243A.
3. FOR CABLE TRIMMING USE KTD-1.
4. FOR CRIMPING USE DIE KTH-2023.
5. MATERIALS:
 INSULATORS: TEFLON, ASTM-D-4894
 SPRING: MUSIC WIRE
 ALL OTHER PARTS: BRASS, ASTM-B16
6. FINISHES:
 SPRING: CADMIUM PLATE PER QQ-P-416
 CENTER CONTACT: GOLD PLATE PER MIL-G-45204
 ALL OTHER METAL PARTS: SILVER PLATE PER QQ-S-365
7. ELECTRICAL CHARACTERISTICS:
 NOMINAL IMPEDANCE: NON-CONSTANT
 VOLTAGE RATING: 500 VRMS
 FREQUENCY RANGE: DC TO 500 MHz

REVISIONS

ISSUE	CHANGES
4	CN 35976 C REDRAWN KH 12/13/94

KAM5106

SCALE	6:1		
APPROX SURFACE AREA			
USED ON			
REF:			
PLUG, KM			
DRAWN	KH	DATE	12/13/94
DESIGN	UJ	DATE	12/14/94
APPR.		DATE	

KINGS
 ELECTRONICS CO., INC.
 TUCKAHOE, NEW YORK 10707

KM-59-08

GSD