

Series VPR  
**5-8, 10-12, 20 Watt**  
 Lug and Lead, Wirewound Resistors

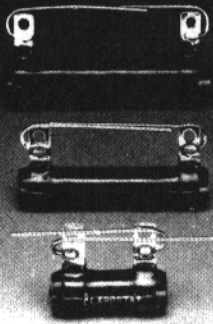

**Description**

The VPR series is a small, highly-durable, power resistor. Its uniform winding and coating provides uniform heat dissipation and excellent appearance. Made in accordance to MIL-R-26 standards, the VPR series offers lead or bracket mounting options.

**Features**

- *Rugged vitreous enamel*
- *Low cost*
- *All-welded construction*
- *Solder lead mounting option*
- *Meets or exceeds MIL-R-26 standards*
- *Non-inductive winding available*

**Series VPR Material Specifications**

*Coating*  
 Conformal vitreous enamel

*Core*  
 Ceramic

*Terminals*  
 Tinned terminals, solderable to MIL-R-26 standards

*Weight*

VPR5F	VPR10F	VPR20H
5 watt	10 watt	20 watt
.192 oz.	.304 oz.	.528 oz.
5.38 gms.	8.51 gms.	14.78 gms.

**Series VPR Electrical Specifications**

*Resistance Tolerance*  
 ±5% 1 ohm and over  
 ±10% under 1 ohm  
 Closer tolerances available

*Power Rating*  
 Based on 25°C free air rating

Series	Minimum Wattage	Maximum Wattage
VPR5F	5	8
VPR10F	10	12
VPR20H	20	20

Figure 1  
**Series VPR Derating**

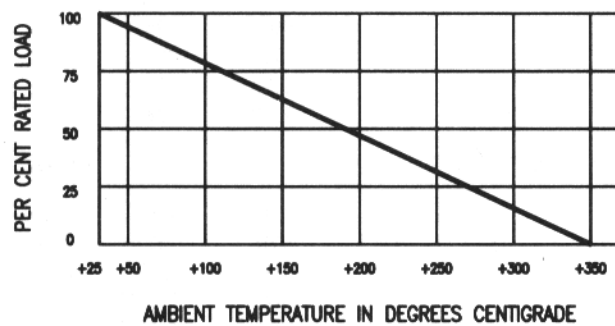

*Overload*  
 10 times rated wattage for 5 seconds

*Temperature Coefficient*  
 ±100 ppm/°C (Closer TC available)

*Dielectric Withstanding Voltage*  
 1000 Vac  
 Lower wattages, maximum hotspot 275°C  
 Higher wattages, maximum hotspot 350°C

Figure 2

Series VPR Dimensions

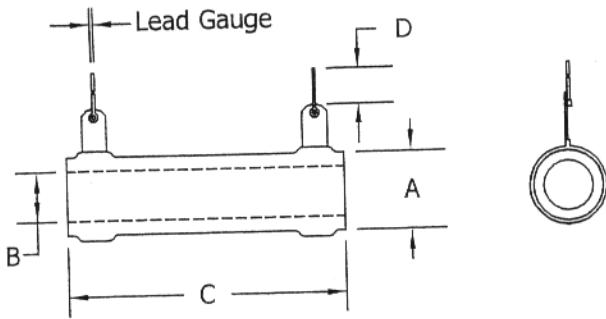

	A*	B*	C*	D**	Lead Gauge
VPR5F	.313	.188	1.000	1.50	18
VPR10F	.313	.188	1.750	1.50	18
VPR20H	.438	.250	2.000	1.50	18

\* Maximum Dimensions  
 \*\* Dimensional Tolerance: ±.250"

**Series VPR Standard Resistance Values**

**Stock Values**

8 WATT		VPR5F			
1	20	200	750	2250	8000
1.5	25	225	800	2500	9000
2	30	250	900	3000	10K
3	35	300	1000	3500	12.5K
4	40	350	1100	4000	15K
5	50	400	1200	4500	17.5K
7.5	75	450	1250	5000	20K
10	100	500	1500	6000	22.5K
12	125	600	1750	7000	25K
15	150	700	2000	7500	

12 WATT		VPR10F			
0.4	20	300	1250	7500	18K
1	25	350	1500	8000	20K
1.2	30	400	1750	8500	22.5K
1.3	35	450	2000	9000	25K
1.5	40	500	2250	10K	30K
2	50	600	2500	11K	35K
3	75	700	3000	12K	40K
4	100	750	3500	12.5K	45K
5	125	800	4000	13.5K	50K
7.5	150	900	4500	14.3K	
10	200	1000	5000	15K	
12	225	1100	6000	16K	
15	250	1200	7000	17.5K	

Standard Resistance Values continued, next column

**20 WATT** **VPR20H**

0.4	250	1200	3500	15K	70K
0.6	300	1250	4000	20K	75K
0.8	350	1500	4500	25K	80K
5	400	1750	5000	30K	85K
10	500	1850	6000	35K	90K
25	650	2000	7000	40K	95K
50	700	2250	7500	45K	100K
75	750	2400	8000	50K	
100	800	2500	9000	55K	
150	850	2750	10K	60K	
200	1000	3000	12.5K	65K	

Notes:

VPR5F: 10 per pack  
 VPR10F: 10 per pack  
 VPR20H: 5 per pack

Special values available, contact Factory  
 Mounting brackets available: style F-100

**Series VPR How To Order**

Series/Wattage + Resistance = Part Number

Example:  
 10-12 watt + 150 ohms = VPR10F-150