

REV	ECN	APP'D
-	4520	IQ 8/21/01
A	4728	IQ 1/24/02
B	5742	RN 12/28/05

ELFP SERIES PART NUMBERING SCHEME

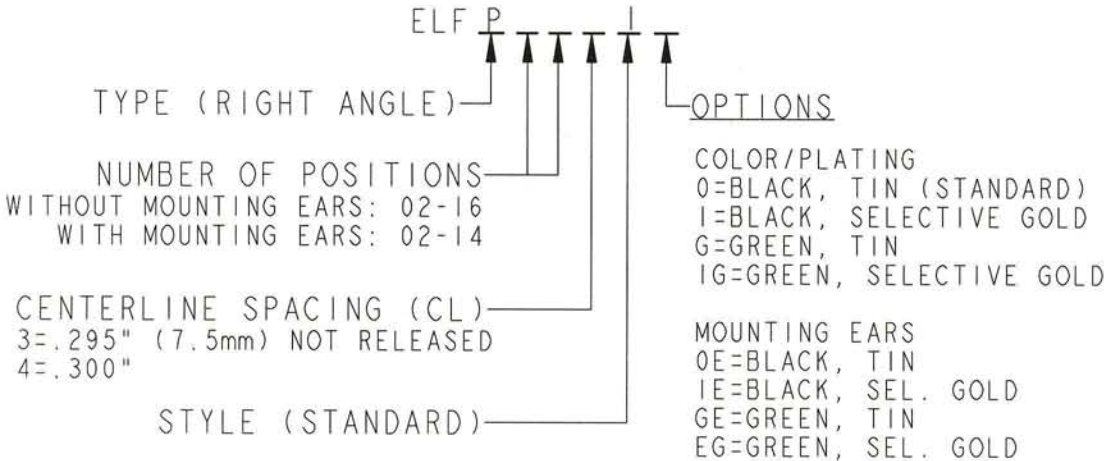

COLOR/PLATING
 0=BLACK, TIN (STANDARD)
 1=BLACK, SELECTIVE GOLD
 G=GREEN, TIN
 IG=GREEN, SELECTIVE GOLD

MOUNTING EARS
 0E=BLACK, TIN
 1E=BLACK, SEL. GOLD
 GE=GREEN, TIN
 EG=GREEN, SEL. GOLD

CONSULT PCD FOR PART NO. AND AVAILABILITY OF FOLLOWING OPTIONS:
 *CUSTOM COLORS
 *CUSTOM MARKING
 *CUSTOM KEYING
 *SELECTIVE CONTACT LOADING

RU RATINGS
 CURRENT - 15A
 VOLTAGE - 300V
 U.L. FILE NO. PENDING

SP RATINGS
 CURRENT - 15 A
 VOLTAGE - 450 V
 CSA FILE NO. PENDING

DIN VDE 0627:1986
 DIN VDE 0110-1:1989
 EN 60947-1:1991
 EN 60947-7-1:1992
 CURRENT - 15 A
 VOLTAGE - 450 V
 TUV FILE NO. PENDING

INSTALLATION RECOMMENDATIONS:
 WIRE RANGE: AWG #14-26, STRANDED OR SOLID; AWG #12 STRANDED
 WIRE STRIP LENGTH: .310"
 TIGHTENING TORQUE: 7 LB-IN.

MATERIALS:
 HOUSING: PPO, UL 94 V-0
 CONTACT: COPPER ALLOY, OPTIONAL FINISH
 SCREW: STEEL, NICKEL FINISH
 WIRE CLAMP: COPPER ALLOY, NICKEL FINISH
 MAX OPERATING TEMPERATURE: 105°C

DIMENSIONS ANSI Y14.5M UNITS: INCHES Pro/E FILE	TOLERANCES .XX ±0.01 .XXX ±0.005 ANGLES ±1.0°	PROJECTION 	<h2>Amphenol Pcd</h2>		TITLE ELFP SERIES PLUG RIGHT ANGLE 7.5mm/.300 PITCH		
			ENGR S.HORNER 30-Jul-01				
ORIGINAL STAMPED IN RED	THIS DOCUMENT CONTAINS PROPRIETARY INFORMATION WHICH IS THE CONFIDENTIAL PROPERTY OF AMPHENOL PCD, INC. PEABODY, MA, USA		CHKD IAN QUINN 21-AUG-01	SIZE A	DWG NO. ELFP02410	REV B	
			APPD IAN QUINN 21-AUG-01	CODE: 58982	SCALE: NONE	SHEET 1 OF 2	

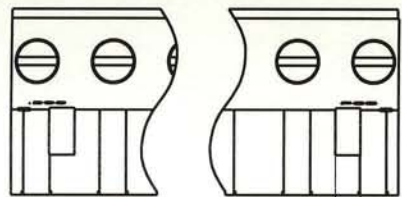

WITHOUT MOUNTING EARS

$$L = (\text{NUM OF POS} \times \text{CL}) - .1$$

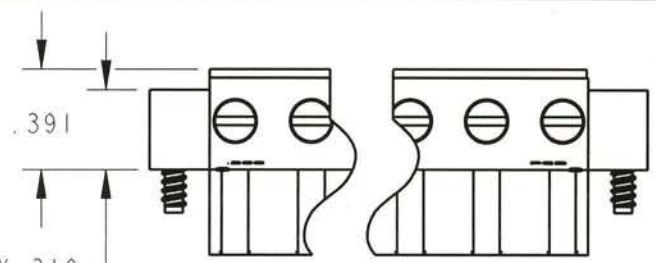
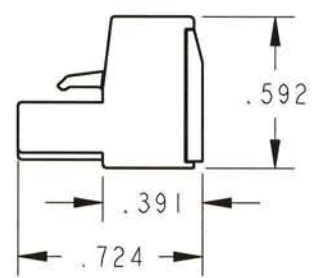
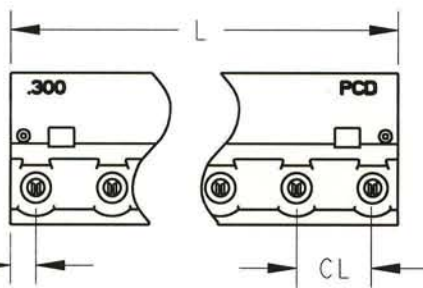
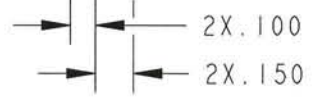

WITH MOUNTING EARS

$$L = (\text{NUM OF POS} \times \text{CL}) - .1$$

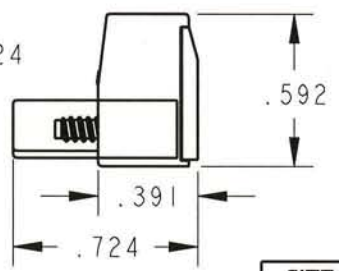
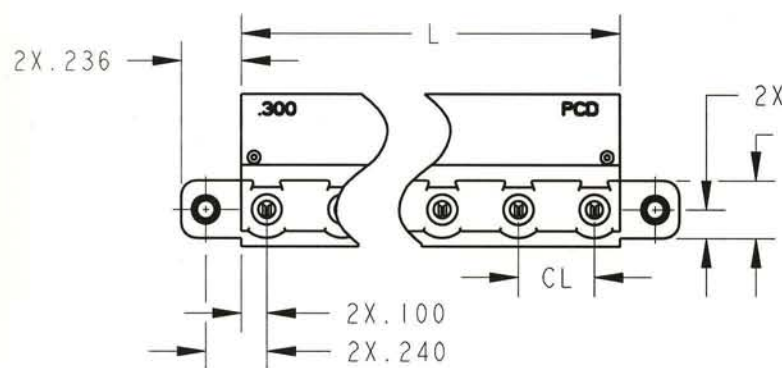

SIZE	DWG NO.	REV
A	ELFP02410	B
CODE: 58982	SCALE: NONE	SHEET 2 OF 2