

DATECODE REPRESENTED:
 1-4 = YEAR QUARTER
 99 = LAST 2 DIGITS OF YEAR

REV NC HDFB-12-02S

REVISIONS			
SYM	DESCRIPTION	DATE	APPROVED
NC	NEW RELEASE PER E.O. P16104	6-11-99	RDR

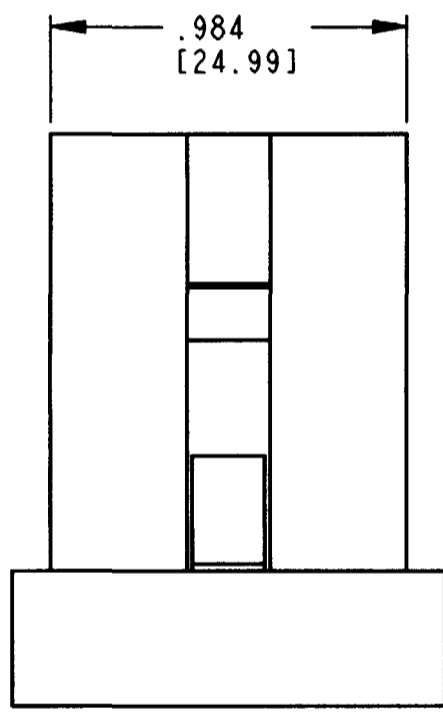
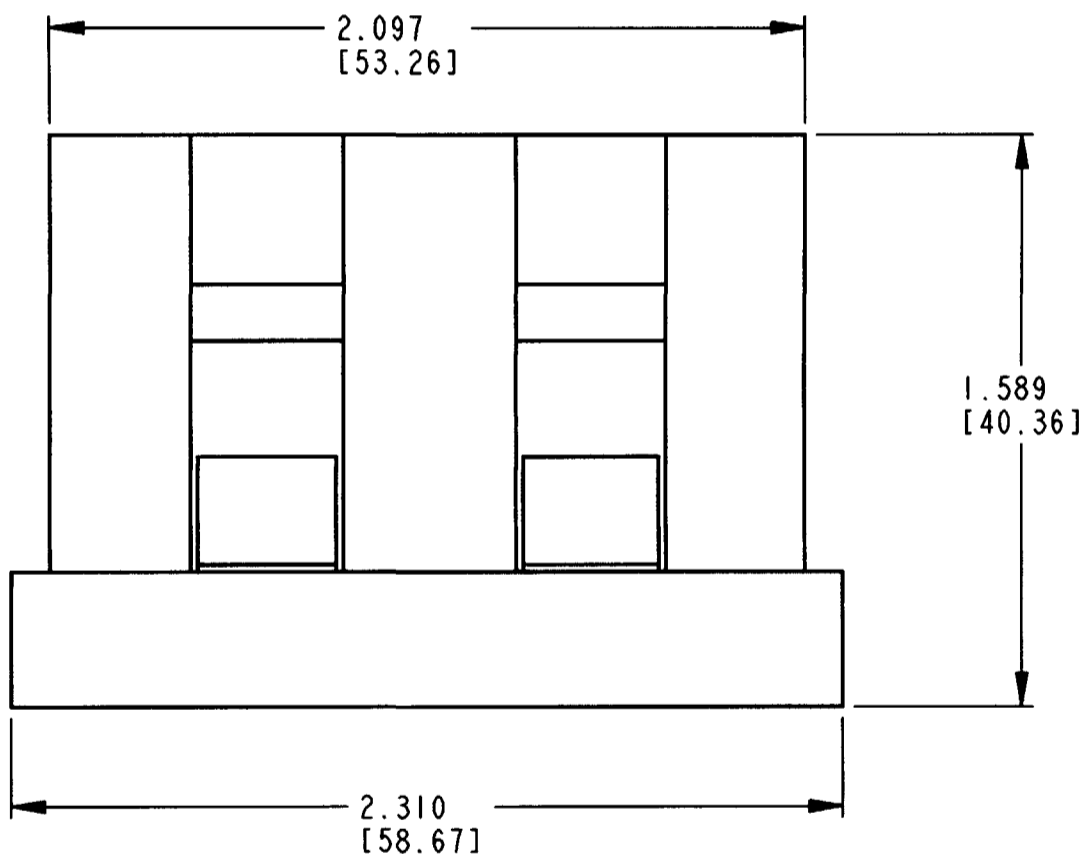
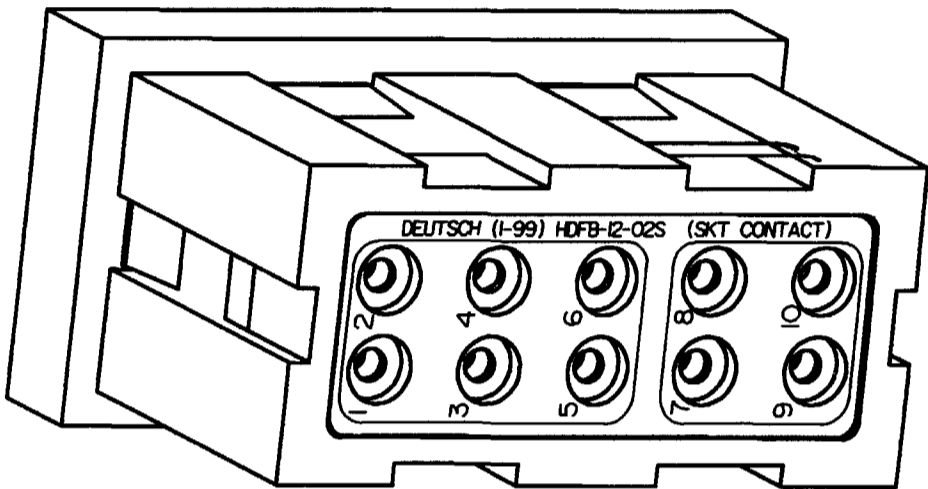
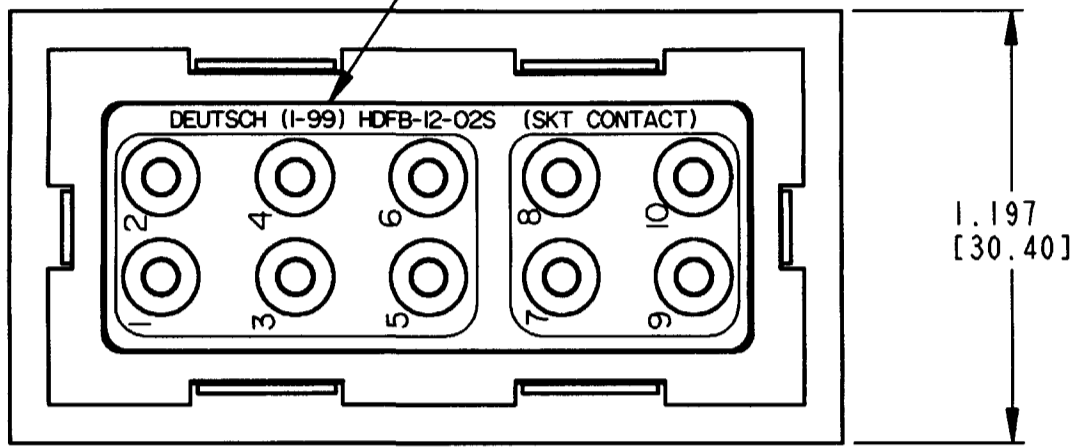

CONTACT SIZE	MIN. INSUL O.D.	MAX. INSUL O.D.	WIRE RANGE [mm ²]
12	.134 [3.40]	.170 [4.32]	12 & 14 AWG [3.0 - 2.0]

4. USE MOUNTING BRACKET 0427-202-0290 (2 MODULES) OR 0427-201-0390 (3 MODULES).
3. FOR CONTACT AND WIRE SPECIFICATIONS INFO. SEE ENVELOPE DRAWING 0425-015-0000. CONSULT FACTORY FOR MODIFICATIONS.
2. ALL DIMENSIONS ARE ±.025 [0.63] UNLESS OTHERWISE SPECIFIED.

NOTES: 1. ALL DIMENSIONS ARE IN INCHES [MILLIMETERS].

SIGNATURE & DATE	
DR	D. SPENCER 12MAY99
CHK	<i>[Signature]</i>
PE	<i>[Signature]</i> 6-8-99
APPD	R. Reed 6-11-99
SCALE	2:1 WT

FEEED BACK MODULE
 10 #12 CONTACTS
 -02 ARRANGEMENT
 HD SERIES

ENVELOPE

CP	MATL. CODE
The Deutsch Company DEUTSCH I.P.D. 3850 INDUSTRIAL AVE. HEMET, CALIF. 92545	
B	HDFB-12-02S
DWG SIZE	CODE SHEET OF
11139	