

KEMET Part Number: SS11H-R10093-CH
(UAL11HR10093CH)

Commercial Grade, SS11V/H-CH, 9300 uH

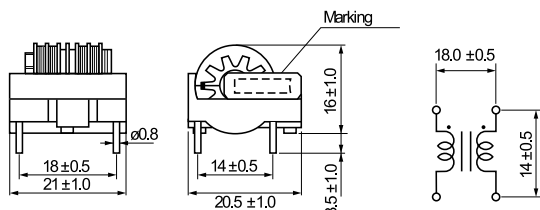

Dimensions

L	21mm +/-1mm
T	20.5mm +/-1mm
H	16mm +/-1mm
S	14mm +/-0.5mm
S1	18mm +/-0.5mm
LL	3.5mm +/-1mm
F	0.8mm NOM

Packaging Specifications

Weight:	11.1 g
----------------	--------

General Information

Style:	Through-Hole Choke
Series:	SS11V/H-CH
Description:	Common Mode Filter
RoHS:	Yes
Miscellaneous:	Inductance Measurement Condition: 1kHz 1V KC530

Specifications

Inductance:	9300 uH
Rated Temperature:	120C
Current:	1 mAmps (Irms, 45C Rise By Self Heating)
Voltage AC:	250 VAC
DC Resistance:	440 mOhms
Insulation Resistance:	100 MOhms