

REV.	ECN NO.	DATE	SIGN	DESCRIPTION
A		2018/04/19	Brady	New Initial

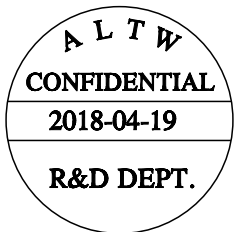
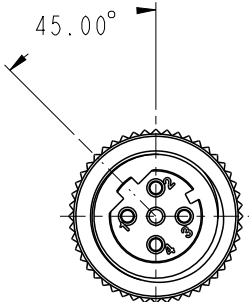
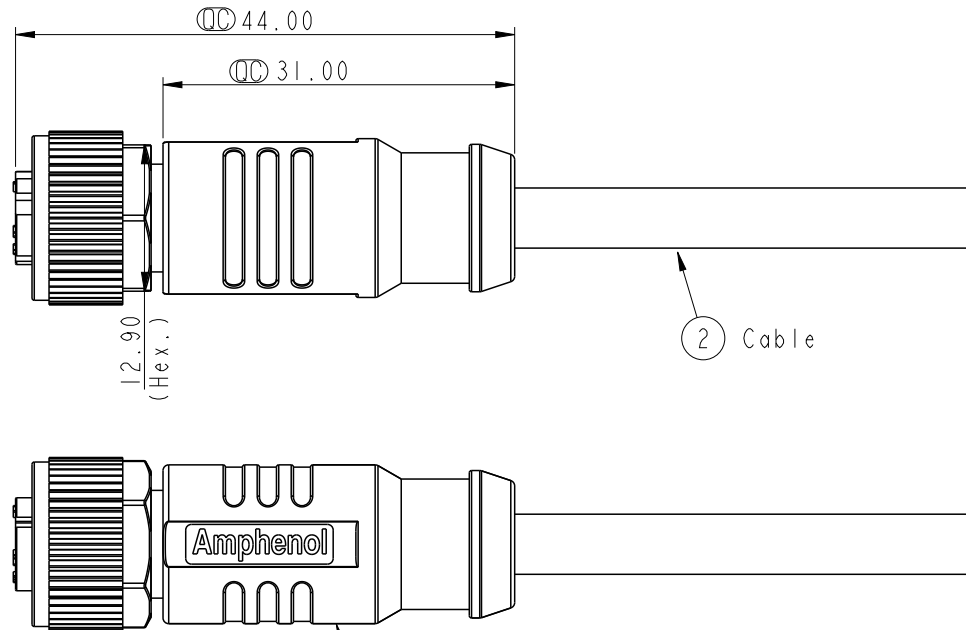

- Notes:
- \*  $\varnothing$  Important Dimension.
  - \* Waterproof Rate: IP68(Under water 1M for 24Hrs).
  - \* Connector: Nylon+GF, Black.
  - \* Female Pin: Copper Alloy, Gold Plated.
  - \* Screw Nut: Zinc Alloy, Nickel Plated.
  - \* Outer Mold: PP, Black.
  - \* Cable: UL2517, Shield, PVC Jacket,UV resistant. Black.  
UL20549,Shield, PU Jacket, Black.
  - \* Rated Voltage: 3 & 4Pin 250V dc. or ac.  
5Pin 60V dc. or ac.
  - \* Rated Current: 3~5Pin 4A
  - \* Operating Temperature: -25~85°C

UNIT:mm		
TOLERANCE		
±0.5mm		

TITLE M12 Shielded D Code Cable Female Conn.		
SCALE 3:2	SIZE A4	SHEET 1 OF 3
REV. A	WC-REV. A.3	$\varnothing$ : Inspection item

**Amphenol LTW**  
安費諾亮泰企業股份有限公司

ITEM NO	DRAWN BY Brady	DATE 2018/04/19
DWG NO MSDS-XXBFFM-SL8XXX	CHECKED BY Neo	DATE 2018/04/19
CUSTOMER ALTW	APPROVED BY Max	DATE 2018/04/19

THIS DOCUMENT IS SUBJECT TO CHANGE WITHOUT NOTICE. IT IS CONFIDENTIAL AND A PROPERTY OF Amphenol LTW. DISCLOSURE TO THIRD PARTY HAS TO BE AUTHORIZED BY Amphenol LTW.

THIS DOCUMENT IS SUBJECT TO CHANGE WITHOUT NOTICE. IT IS CONFIDENTIAL AND A PROPERTY OF Amphenol LTW. DISCLOSURE TO THIRD PARTY HAS TO BE AUTHORIZED BY Amphenol LTW.

4P	PU	5.3	22	MSDS-04BFFM-SL8EXX
4P	PVC	5.3	22	MSDS-04BFFM-SL8DXX
Contacts	Cable Jacket	Cable OD	AWG	Item No.

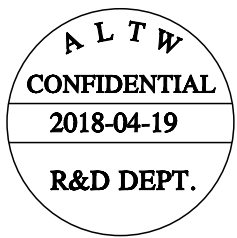

M SDS - XX B F F M - S L 8 X XX

SDS: A-Code Shielded

04: 4Pin

XX: 01~99Meters  
 01: 01Meter  
 02: 02Meters  
 ...  
 99: 99Meters

D: PVC UL2517 Cable, Black (PVC黑色外被線材)  
 E: PU UL20549 Cable, Black (PU黑色外被線材)

8: IP68 (防水等級68)

L: Straight (180° 線端)

S: Screw (螺紋式)

M: Molding Type (射出成型)

B: Cable Without S/R (線端無網尾)

M: Female Connector (母座)

M: Female Pin (母Pin)

UNIT: mm	
TOLERANCE	±0.5mm

TITLE M12 Shielded D Code Cable Female Conn.			
SCALE 3:2	SIZE A4	SHEET 2 OF 3	
REV. A	WC-REV. A.3	QC: Inspection item	

**Amphenol LTW**  
 安費諾亮泰企業股份有限公司

ITEM NO	DRAWN BY Brady	DATE 2018/04/19
DWG NO MSDS-XXBFFM-SL8XXX	CHECKED BY Neo	DATE 2018/04/19
CUSTOMER ALTW	APPROVED BY Max	DATE 2018/04/19

THIS DOCUMENT IS SUBJECT TO CHANGE WITHOUT NOTICE. IT IS CONFIDENTIAL AND A PROPERTY OF AMPHENOL LTW. DISCLOSURE TO THIRD PARTY HAS TO BE AUTHORIZED BY AMPHENOL LTW.

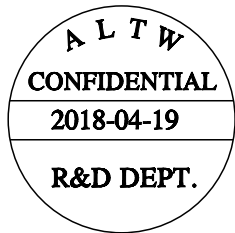

4	Black	黑
3	Blue	藍
2	White	白
1	Brown	棕

Pin # Wire

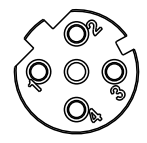

4P

UNIT:mm		
TOLERANCE		
±0.5mm		

TITLE M12 Shielded D Code Cable Female Conn.		
SCALE 3:2	SIZE A4	SHEET 3 OF 3
REV. A	WC-REV. A.2	: Inspection item

**Amphenol LTW**  
安費諾亮泰企業股份有限公司

ITEM NO	DRAWN BY Brady	DATE 2018/04/19
DWG NO MSDS-XXBFFM-SL8XXX	CHECKED BY Neo	DATE 2018/04/19
CUSTOMER ALTW	APPROVED BY Max	DATE 2018/04/19