

Vinyl Fully Insulated Female Disconnects



110 Tab Size



187 Tab Size



250 Tab Size

- Fully Insulated
- Brazed Seam
- Internal Barrel Serrations
- Funnel Entry

Catalog Number	Wire Range	Tab Size inch	Dimension ^{inch} / _{mm}					
			W	F	L	B	D	T
KVF18-110-20FDM	22-16 A.W.G. 0.5-1.5 mm ²	.110 x .020	.126 3.2	.256 6.5	.748 19.0	.413 10.5	.150 3.8	.012 0.3
KVF18-110-32FDM		.110 x .032	.126 3.2	.256 6.5	.748 19.0			
KVF18-187-20FDM		.187 x .020	.197 5.0	.252 6.4	.807 20.5	.413 10.5	.185 4.7	.016 0.4
KVF18-187-32FDM		.187 x .032	.197 5.0	.252 6.4	.807 20.5			
KVF18-250FD-M		.250 x .032	.260 6.6	.287 7.3	.858 21.8			
KVF14-110-20FDM	16-14 A.W.G. 1.5-2.5 mm ²	.110 x .020	.126 3.2	.256 6.5	.748 19.0	.413 10.5	.185 4.7	.012 0.3
KVF14-110-32FDM		.110 x .032	.126 3.2	.256 6.5	.748 19.0			
KVF14-187-20FDM		.187 x .020	.197 5.0	.252 6.4	.796 20.2	.413 10.5	.185 4.7	.016 0.4
KVF14-187-32FDM		.187 x .032	.197 5.0	.252 6.4	.796 20.2			
KVF14-250FD-M		.250 x .032	.260 6.6	.287 7.3	.874 22.2			
KVF10-250FD-D	12-10 A.W.G. 4-6 mm ²	.250 x .032	.260 6.6	.287 7.3	.953 24.2	.492 12.5	.244 6.2	.016 0.4

Box Quantity: (D)=500; (M)=1000

For Mylar Tape replace box quantity with (T). Example: KVF18-110-20FD-T

UL File #E66716

CSA File #LR4503

See pages in back of catalog for complete tool information.
Tool and Die Selection Chart on page M42.

Maximum Electrical Rating: 105°C 300 Volts Max.

Terminal Material: Brass with Copper Sleeve

Tools used with Vinyl Fully Insulated Female Disconnects: ERG2500 and KT2500.

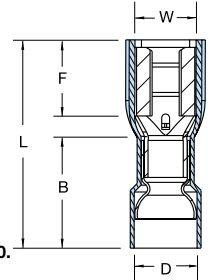

M

Spec-Kon®



- Fully Insulated
- Metal Insulation Sleeve
- Molded Insulator
- Internal Barrel Serrations
- Funnel Entry

Nylon Fully Insulated Male Disconnects

Catalog Number	Wire Range	Tab Size inch	Dimension ^{inch} / _{mm}					
			W	F	L	B	D	T
KNF18-250MD-D	22-16 A.W.G. 0.5-1.5 mm ²	.250 x .032	.250 6.35	.303 7.7	.976 24.0	.433 11.0	.157 4.0	.016 0.4
KNF14-250MD-D	16-14 A.W.G. 1.5-2.5 mm ²	.250 x .032	.250 7.7	.303 24.0	.976 25.8	.433 11.0	.197 5.0	.016 0.4
KNF10-250MD-D	12-10 A.W.G. 4-6 mm ²	.250 x .032	.250 6.35	.303 7.7	1.016 25.8	.512 13.0	.256 6.5	.016 0.4

Box Quantity: (D)=500

UL File #E66716

CSA File #LR4503

See pages in back of catalog for complete tool information.
Tool and Die Selection Chart on page M42.

Maximum Electrical Rating: 105°C 600 Volts Max.

Terminal Material: Brass with Copper Sleeve

Yellow Male Disconnect Not Shown.

Tools used with Nylon Fully Insulated Male Disconnects: ERG2500 and KT2500.

