

100 Amp

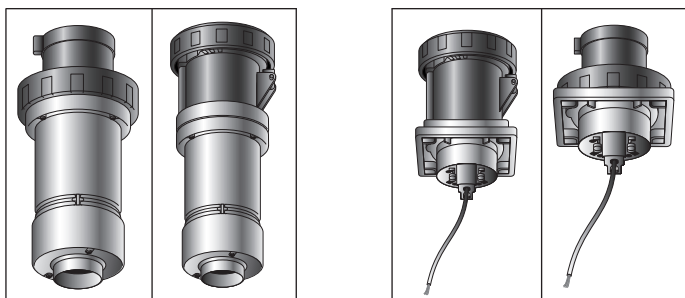

	Poles & Wires	Configuration			Voltage/ Color Coding	Plug	Connector	Cable O.D. Range Inches	Receptacle*	Inlet*
		Receptacle/ Connector	Plug/ Inlet	Clock Hour						
WATERTIGHT IP67	2P3W**			6h	250	RS3100P6W	RS3100C6W	1.2650-1.790	RS3100R6W	RS3100B6W
	2P3W**			7h	480	RS3100P7W	RS3100C7W	1.2650-1.790	RS3100R7W	RS3100B7W
	3P4W			12h	125/250	RS4100P12W	RS4100C12W	1.2650-1.790	RS4100R12W	RS4100B12W
	3P4W			9h	3Ø250	RS4100P9W	RS4100C9W	1.2650-1.790	RS4100R9W	RS4100B9W
	3P4W			7h	3Ø480	RS4100P7W	RS4100C7W	1.2650-1.790	RS4100R7W	RS4100B7W
	3P4W			5h	3Ø600	RS4100P5W	RS4100C5W	1.2650-1.790	RS4100R5W	RS4100B5W
	4P5W			9h	3ØY120/208	RS5100P9W	RS5100C9W	1.2650-1.790	RS5100R9W	RS5100B9W
	4P5W			7h	3ØY277/480	RS5100P7W	RS5100C7W	1.2650-1.790	RS5100R7W	RS5100B7W
	4P5W			5h	3ØY347/600	RS5100P5W	RS5100C5W	1.2650-1.790	RS5100R5W	RS5100B5W

*See Page 81 for back box/mounting options.

**Alternate vendor supplied item; construction features will vary from specs in this catalog. Full IEC approval and mating guaranteed. Contact tech support for inlet/receptacle mounting components.

UL Listing E2630, E47956
UL Classification E205590

Note: All UniGard 60 & 100 Amp devices ship standard with IEC 309-1 configuration center "pilot" pin/sleeves used for auxillary contact service.

Special construction without these pilots is available.