

Color-Keyed®

Connectors for Aluminum/Copper Code Conductor



Two Hole Lugs – 90°C

600V to 35KV Applications

- AL and CU concentric and compact code AL strandings.
- Connectors are filled with oxide inhibitor compound.

Material – High Conductivity Wrought Aluminum.
Finish – Electro-Tin Plated.

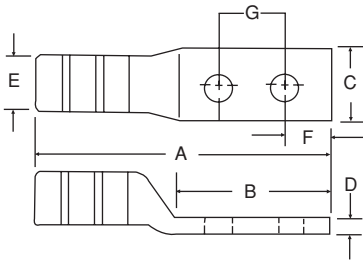

Cat. No.	Cable Size	Bolt Size (in.)	Color Code	Dimensions (in.)						
				A	B	C	D	E	F	G
60230	1/0 AWG	3/8	Tan	3.50	1.90	.880	.19	.62	.38	1.00
60236	2/0 AWG	3/8		3.50	1.90	.970	.22	.70	.38	1.00
60238	2/0 AWG	1/2	Olive	5.03	3.41	.970	.22	.70	.75	1.75
60242	3/0 AWG	3/8		3.66	1.18	1.063	.22	.77	.38	1.00
60244	3/0 AWG	1/2	Ruby	5.16	3.41	1.063	.22	.77	.75	1.75
60248	4/0 AWG	3/8		4.58	1.93	1.210	.25	.86	.38	1.00
60250	4/0 AWG	1/2	White	5.65	3.00	1.210	.25	.86	.50	1.75
60254	250 kcmil	3/8		4.73	1.93	1.290	.27	.92	.38	1.00
60256	250 kcmil	1/2	Red	5.80	3.00	1.290	.27	.92	.50	1.75
60260	300 kcmil	3/8		4.80	1.93	1.390	.28	.99	.38	1.00
60262	300 kcmil	1/2	Blue	5.88	3.00	1.390	.28	.99	.50	1.75
60265	350 kcmil	3/8		5.50	1.93	1.530	.33	1.09	.38	1.00
60267	350 kcmil	1/2	Brown	6.58	3.00	1.530	.33	1.09	.50	1.75
60268	400 kcmil	3/8		5.63	1.93	1.650	.38	1.18	.38	1.00
60269	400 kcmil	1/2	Green	6.70	3.00	1.650	.38	1.18	.50	1.75
60271	500 kcmil	3/8		5.63	1.93	1.790	.38	1.28	.38	1.00
60273	500 kcmil	1/2	Pink	6.70	3.00	1.790	.38	1.28	.50	1.75
60274	600 kcmil	3/8		5.75	1.93	1.920	.37	1.36	.38	1.00
60275	600 kcmil	1/2	Black	6.83	3.00	1.920	.37	1.36	.50	1.75
60276	700 kcmil	3/8		5.88	1.93	2.040	.38	1.44	.38	1.00
60277	700 kcmil	1/2	Purple	6.95	3.00	2.040	.38	1.44	.50	1.75
60278	750 kcmil	1/2	Yellow	7.15	3.00	2.130	.40	1.50	.50	1.75
60284	1000 kcmil	1/2	—	7.78	3.00	2.500	.50	1.77	.50	1.75

Note: Bolt holes 3/8" on 1" centers, 1/2" on 1 1/4" centers.

Range Taking Narrow Tongue Single Barrel Lugs*



Wire barrel factory filled with oxide inhibiting compound.

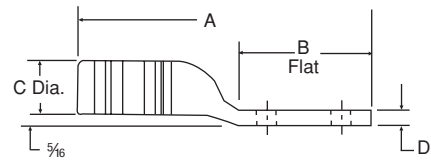
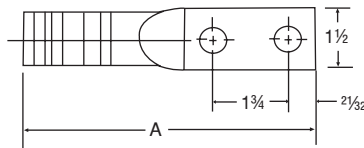

Cat. No.	Al-Cu Cable Range	Bolt Size	Hex Die No.	Color Code	No. of Compressions		Dimensions			
					13642 TBM12M	TBM15	A	B	C	D
60273N	350-500 kcmil	1/2	99H	Pink	4	4	6 7/8	3 1/8	1 3/32	1 3/32
60278N	500-750 kcmil	1/2	115H	Yellow	—	4	7 1/8	3 1/16	1 1/2	1/2

* 90°C, 600V to 35KV applications
All lugs have 1 1/2" wide tongues. Bolt holes on 1 3/4" centers.
Material: Aluminum
Finish: Tin Plated
Tooling: Pg. 79-100
Die Selector Chart: Pg. 105-109